

T-11A CAVITY CARTRIDGE VALVE BODIES

FOR VALVE MODELS: GPOC11, GCB11, GCBS11, GPRD11, GPRV11, GPS11, GPCC11 Series

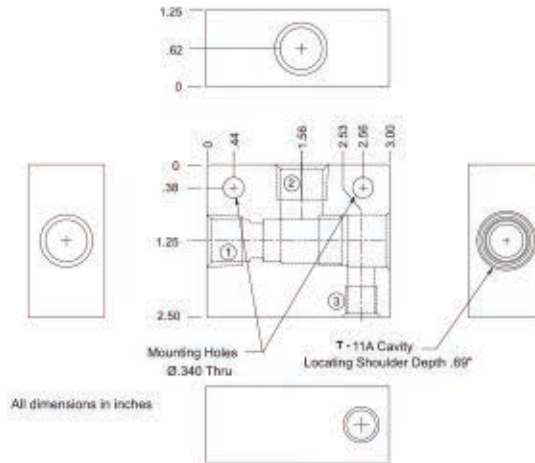

## Ordering Information

G11A  
Base Model #

3P

Port Size

- 3P - 3/8 npt (1/4 npt pilot port)
- 4P - 1/2 npt (1/4 npt pilot port)
- T6 - sae #6 (sae #6 pilot port)
- T8 - sae #8 (sae #6 pilot port)
- T10 - sae #10 (sae #6 pilot port)

A

Material  
A - Aluminum

T-11A CAVITY CROSS-PILOTED VALVE BODIES  
FOR VALVE MODELS: GPOC11, GCB11, GCBS11 Series

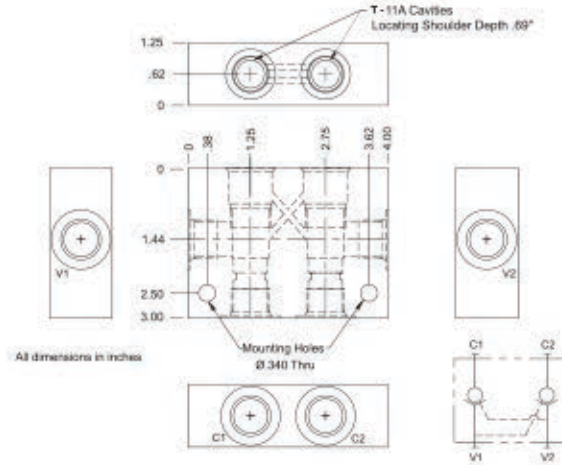

## Ordering Information

G11A-CP  
Base Model #

3P

Port Size  
3P - 3/8 npt  
4P - 1/2 npt  
T6 - sae #6  
T8 - sae #8

A

Material  
A - Aluminum