

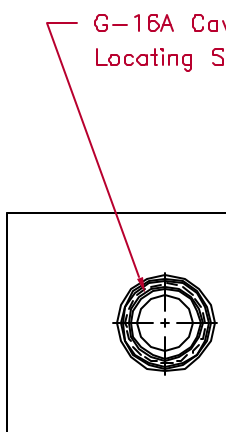

# GOLD SERIES

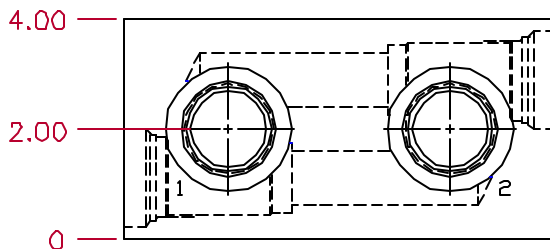

## G-16A CAVITY CROSSOVER RELIEF BODIES



G-16A Cavity  
Locating Shoulder Depth .56"

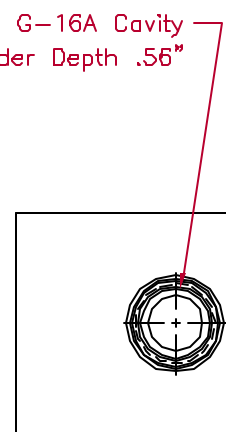

G-16A Cavity  
Locating Shoulder Depth .56"

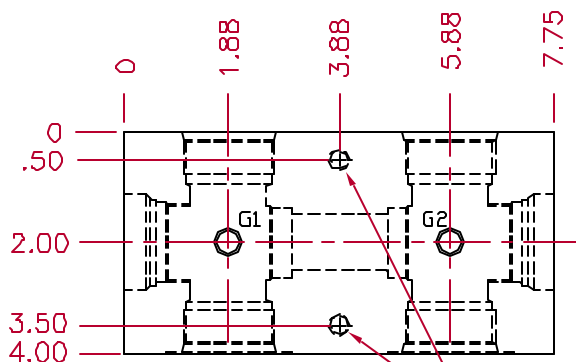

Mounting Holes: (opposite side)  
3/8-16 UNC-2B X .62 Deep

All dimensions in inches

(Gage Ports G1 & G2 are 1/4 NPTF)

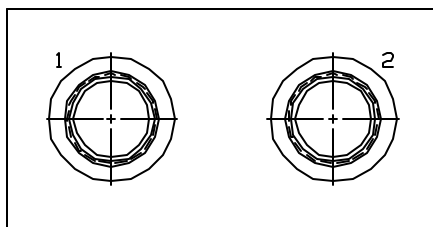

### ORDERING INFORMATION

**G16A-XR** - **10P** **A**

Body Series ————

Port Size (1 & 2) ————

Block Material ————

A - Aluminum

10P - 1 1/4 NPTF

T20 - 1 1/4 SAE(#20)

Typical cartridges  
used with this body

GPR16 - \*\*\*\*\*

